

# Harmonize Your Home



*Annette Kurtz*

## **Tip # 42**

Enhance Your Life  
with the Bagua

# Recognize the Bagua in Your Home

## Tip #42

### 01. The Bagua Map

"Bagua" means 8 trigrams arranged around a center. The 8 trigrams are considered the 8 corners of a home and adding the center makes it 9 areas of life.

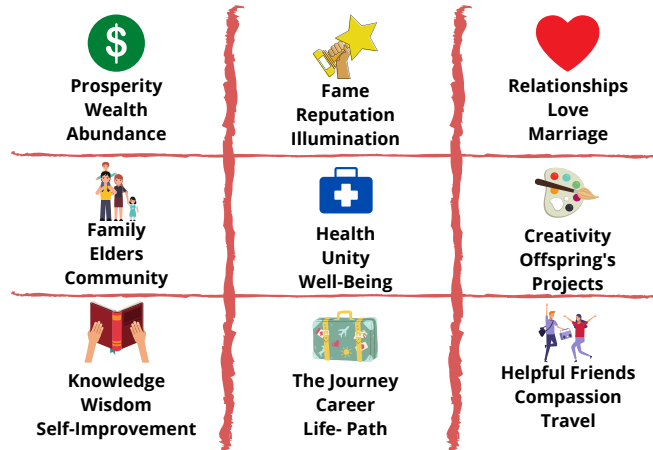

### 02. Your Floorplan

This is an example of a floorplan. Get a copy of your floorplan or draw one up. Turn it so the entrance to your home is located at the bottom of the sheet.

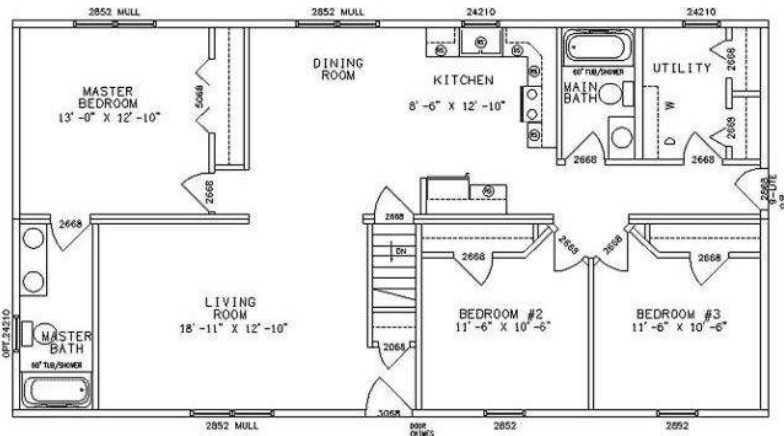

Entrance

### 03. Discover the 9 Life Areas in Your Home

Divide your floorplan into 9 equal parts and place the Bagua Map on top. To change an aspect of your life, change the flow in that area of your home.

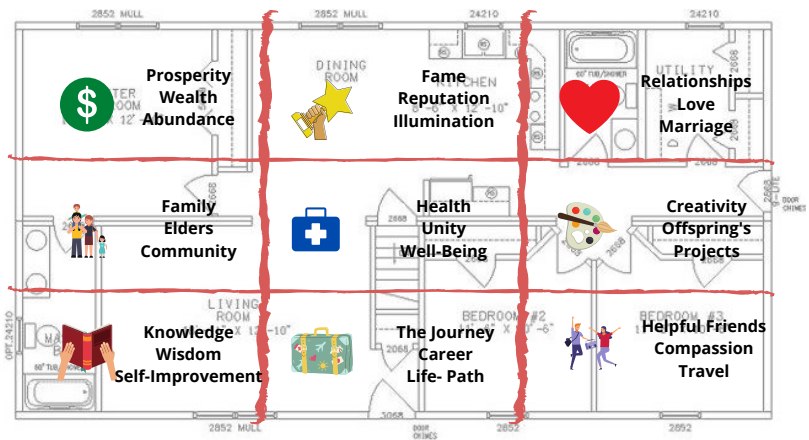

Entrance